

# LED Tube (2 feet)

## LI04-580 (Daylight) / LI04-580 (Warm White)

### Features



- Supply Voltage : DC 24V
- No starter applied. Replace the traditional fluorescent tube directly.
- Quick lighting up, no flicker.
- Aluminum alloy main body helps better heat dissipation.
- No UV and radiation.
- Low power consumption, save more energy and Save more money.
- No pollution, and recyclable. Conforms to ROHS compliant.
- Compatible with T8/T10 lighting fixture.
- Operating temperature : -30°C ~ 45°C
- Storage temperature : -40°C ~ 80°C
- Long life (40,000 hours at ambient temperature 25°C)
- Able to be used in office illumination, home illumination, building construction or decoration illumination... and so on.

### Specifications

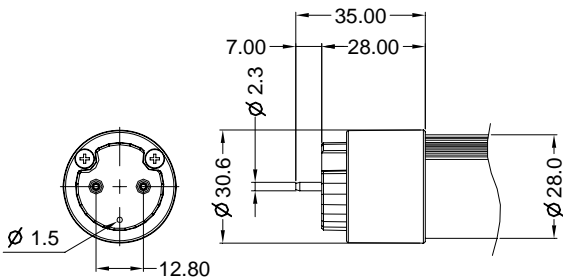
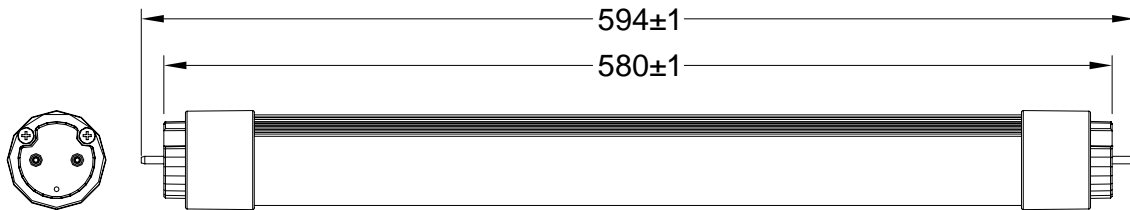

LED Type	SMD3020 LED * 144 pcs
Color Temperature	(Daylight) 5600~6300K (Warm White) 2800~3200K
Base Type	T8 & T10
Dimension	φ 28mm x 580mm
Input Voltage	24 VDC
Power Consumption	10W Max (w/o Adaptor)
Power Efficiency	94%
Operating Temperature	-30°C ~ +45°C
Storage Temperature	-40°C ~ +80°C
Weight / Unit	170g
Illumination Angle	145°
Lumen	700 lm
Color Rendering Index	70
Illuminance	250 Lux ( 4 tubes at 2M height)
Lifetime	Up to 40,000 Hours , Ta 25°C
Housing	Aluminum alloy + PC